

CHAPERONE GUIDE

Thank you for being a chaperone!

Thank you for being a chaperone! Your participation is vital in making sure that students have a meaningful experience. If you are engaged and curious about the artwork, exhibits and activities, the students will follow your example. Here are some guidelines to make your trip as positive as possible:

ACTIVELY PARTICIPATE in the learning experience, engage in the hands-on activities and interact with exhibitions. Don't be afraid to play alongside the students!

NON-FLASH PHOTOGRAPHY is allowed. Some objects are touchable, some are not: please consult gallery signage.

ALL STUDENTS MUST BE SUPERVISED at all times. Please learn the names and faces of the students in your group.

Please help prompt students to use their **WALKING FEET AND INSIDE VOICES**.

FOOD AND DRINK may only be consumed in the atrium (chewing gum is not allowed).

BACKPACKS AND LARGE BAGS may be carried down at your side, or feel free to leave them safely on the field trip cart.

PLEASE ADHERE TO SCHEDULED TIMES for programs, lunch, and teacher guided exploration.

HELP STUDENTS EXPLORE by asking open-ended questions. Remember that you don't have to know the answers. You can ask things like:

What do you like about this exhibit, object, or activity?

How do you think this works? Why?

How do you know?

What happens if/when...?

What do you like about...?

IN CASE OF EMERGENCY or a lost child, please alert a museum employee immediately for help.

Most importantly: have fun!

Students In My Group:

Education programs made possible through the generous support of:



COOK INLET REGION, INC.

MARY ELLEN SEGELHORST

MAP

1st Floor

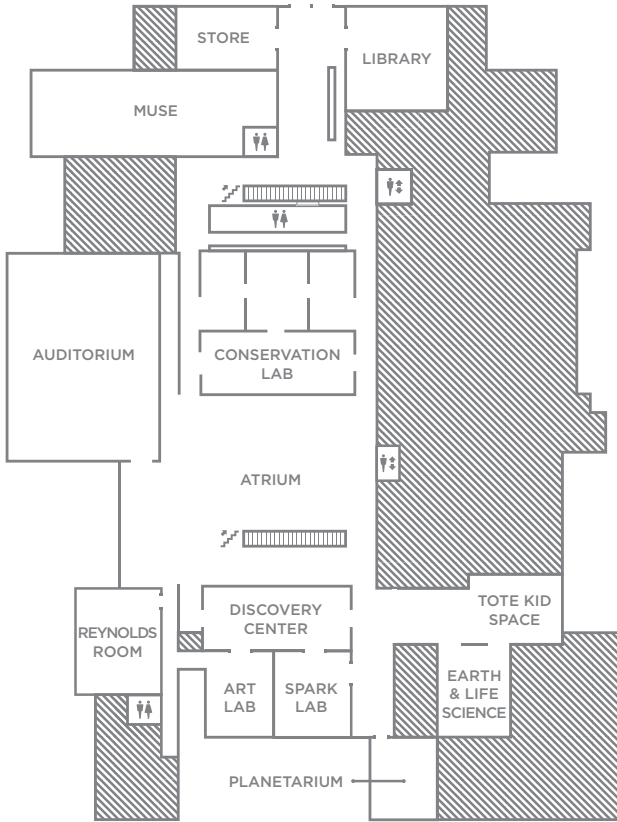

2nd Floor

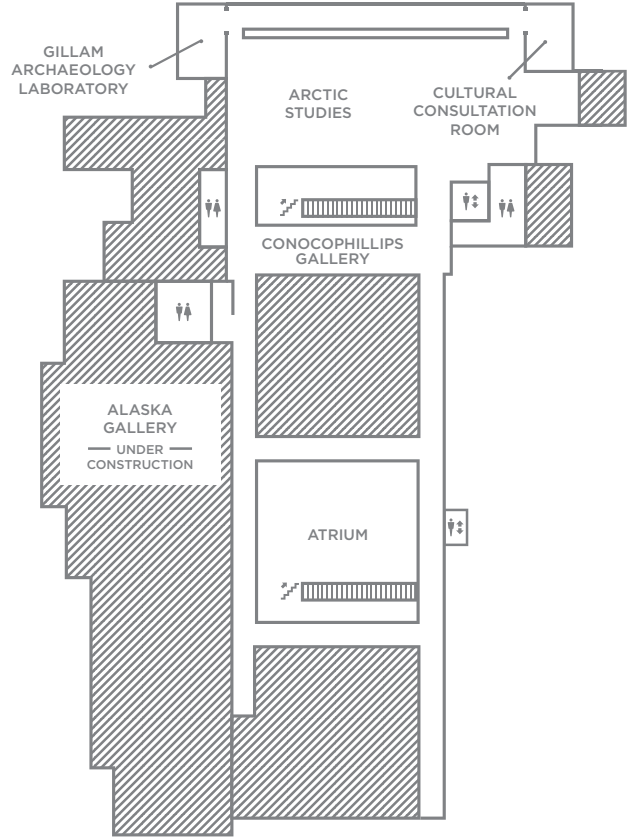

3rd Floor

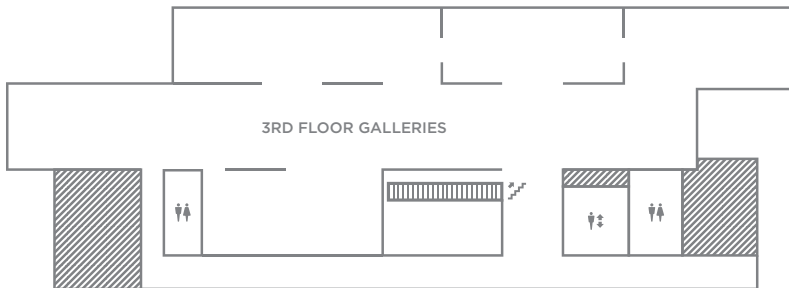

4th Floor

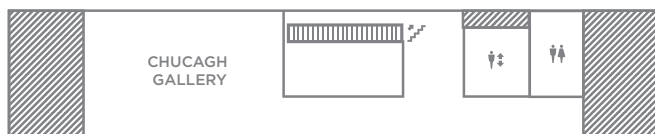

MAP LEGEND



STAIRS



ELEVATOR



RESTROOMS



ADMIN AREAS